

Universal DIY cabinet dedicated for all Cube 10" drivers.

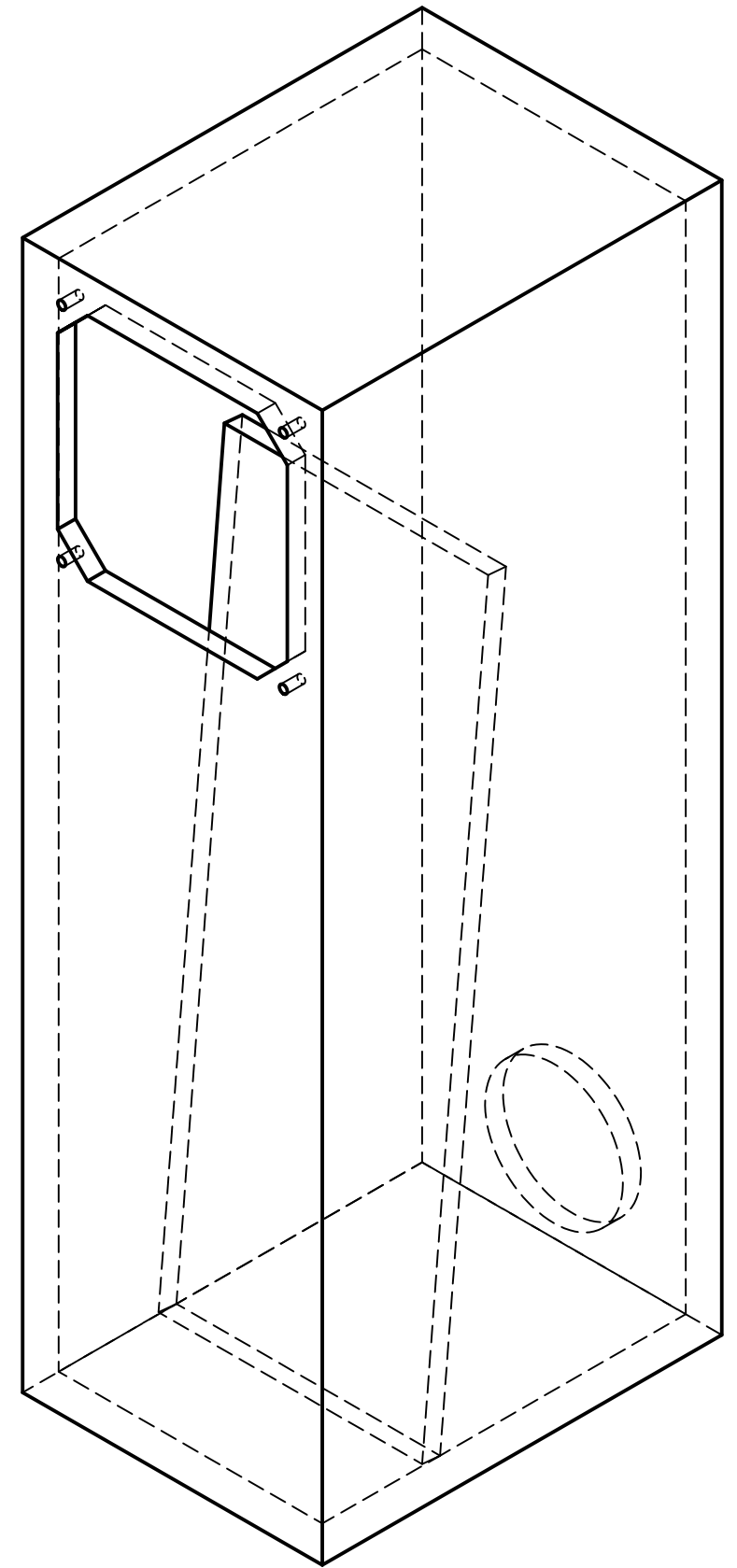
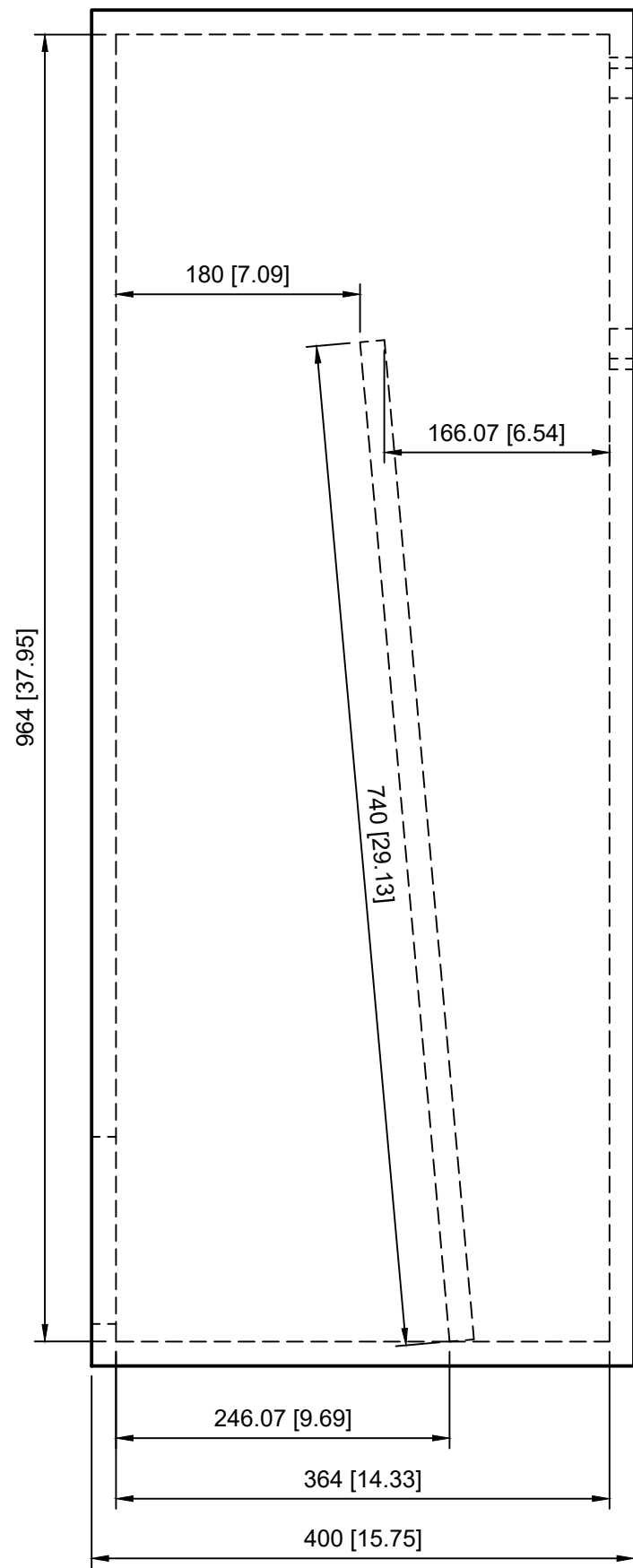
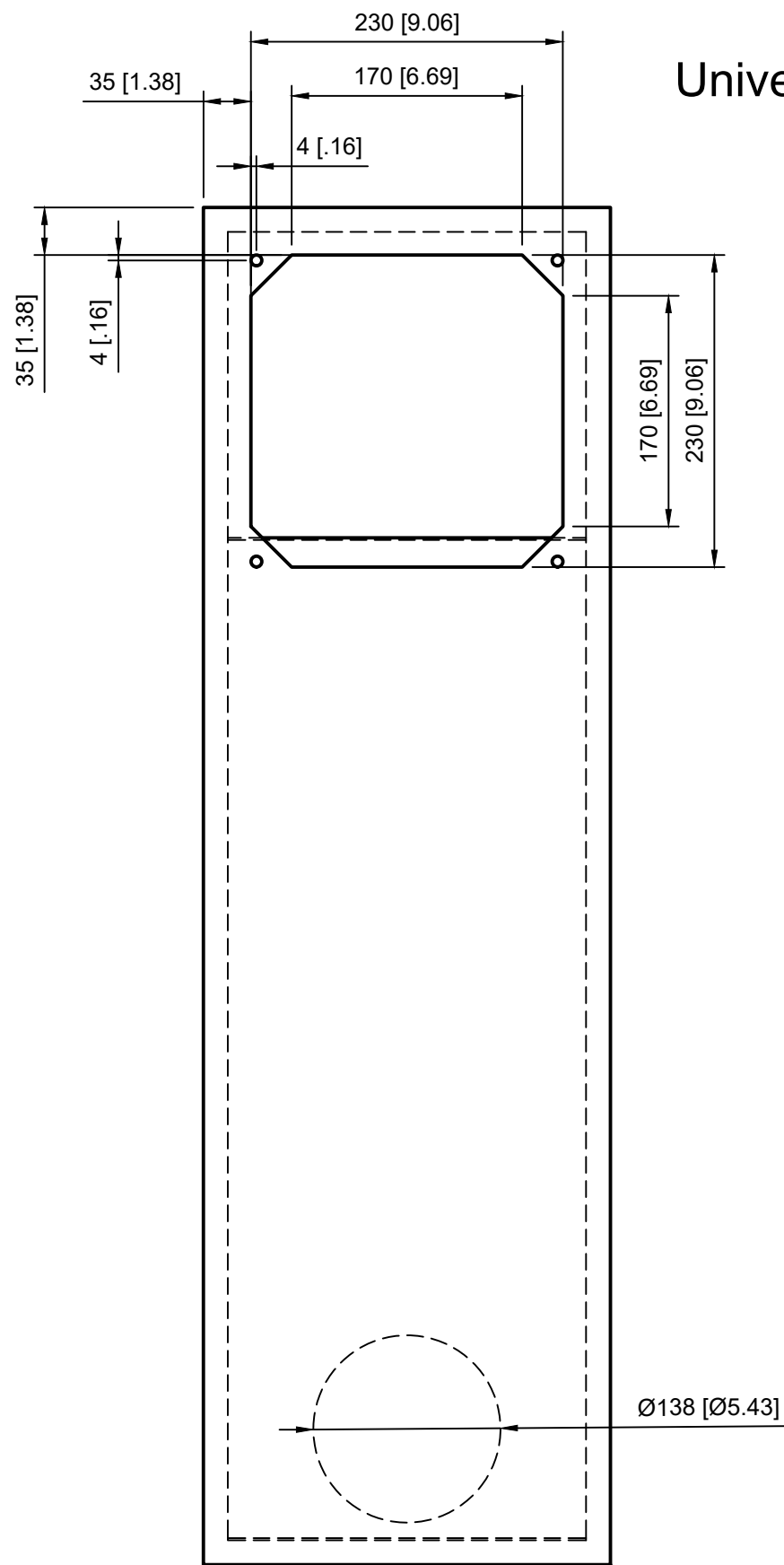

Recommended material - 18 mm MDF. Acoustic foam is recommended on all interior sides except side walls (front, top, back and 740 mm partition on both sides). Acoustic wool can also be used, but the wool shouldn't be placed near the port (opening on the back). The opening on the back has a diameter of 138 mm and is prepared for the MONACOR BR -100HP port. The speakers can be tuned to the room and electronics. The port can be left without BR tube or the Monacor BR -100HP or similar port, which has an inner diameter of about 100 mm, can be used. In our experience, it's best to buy 4 or 6 ports and shorten them with a saw to get different lengths and tune the speakers to your taste.